



# REC 280-320

## Centralized Heat Recovery Unit

Up to  
10 rooms

### Energy Class A (REC320)

- Tested by BRE according to EN308 ErP come REC in linea
- Integrated by-pass on both models

### DESCRIPTION

- High efficiency centralized heat recovery units with thermal efficiency up to 93%.
- Centralized heat recovery unit for vertical installation.
- Suitable for  $\varnothing$  125 mm ducting system.
- Casing made in galvanized steel sheet with epoxy finish
- Internal panels in PPE for a perfect thermal and acoustic insulation.
- Integrate or optional by-pass.
- Multispeed high efficiency motors.
- Low sound level.
- Integrated filter system class G4.
- Supplied with RLS 1WR control panel (EC motor versions).
- IPX4.
- Comply with EN 60335-2-80, B.T. 2006/95/CE, EMC 2004/108/CE
- Performance measured by BRE according to EN 13141-7, EN 13101-4, EN 5801 and EN 308.
- **CE** marked

### OPERATION

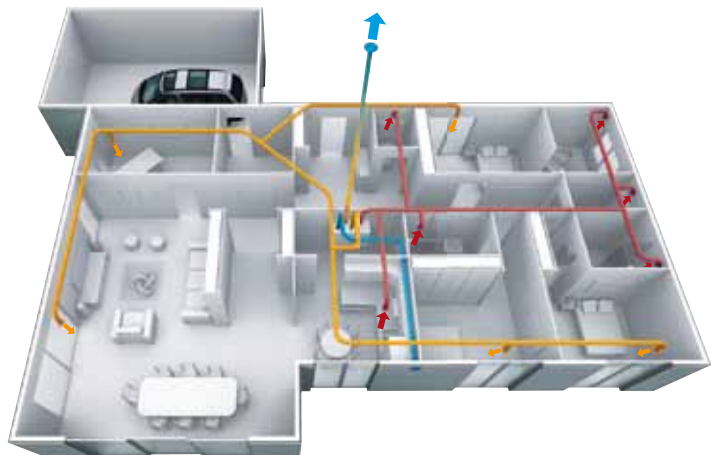

The centralized HRU is located in a technical room or in a false ceiling. The hot internal air extracted from the premises goes through a heat exchanger before being expelled outside. The fresh air coming from outside is first filtered and then goes through the exchanger where it recuperates the heat released by the extracted air.

### CONTROLLERS

#### SUPPLIED

##### RLS 1 WR

- Remote control
- Manual selection of three modality of continuous running:
  - I - Low ventilation modality
  - II - Intermediate ventilation modality
  - III - Intensive ventilation modality
- supply voltage 230V – 50/60 Hz
- Weight 0,50 Kg
- Dimensions 75 x 75 x 30



Supplied with REC 320

#### ACCESSORY

##### RLS 3V - 3 speeds

- Remote 3 speed control (Min/Max) and On/Off switch
- New design with cover
- Suitable for surface or built-in installation
- Ease of connection by the means of removable terminals
- Protection IP42
- Weight 0,40 Kg
- Supply voltage 230V – 50/60 Hz
- Dimensions 110 x 80 x 42



Suitable for REC 280

# MODELS



## REC 280 AC

- Provided with external rotor motor and forward blade impeller 2 speed running: continuous running at the minimum speed, maximum speed is activated through remote control.
- Ideal for houses up to **10 rooms**.
- Installation configuration: **5 intake points and 5 extract points**.
- Max airflow **280 m³/h**.
- High efficiency heat recovery: **93%**.
- Made in steel with epoxy finish.
- Ducting system  $\varnothing$  125 mm.
- Integrated filter system class G4, easily removable.
- **Integrated by-pass**.
- **AC motor**.



## REC 320 EC

- Provided with brushless motor for an optimal combination between high performance, silence and low energy consumption.
- Ideal for houses up to **10 rooms**.
- Installation configuration: **5 intake points and 5 extract points**.
- Max airflow **320 m³/h**.
- High efficiency heat recovery: **93%**.
- Made in steel with epoxy finish.
- Ducting system  $\varnothing$  125 mm.
- Integrated filter system class G4, easily removable.
- **Integrated by-pass**.
- **EC motor**.

# PERFORMANCE

| MODEL  | AIRFLOW MAX |     | V<br>at 50 Hz | W<br>max | A<br>max | dB (A)* | Kg   |
|--|-------------|-----|---------------|----------|----------|---------|------|
|  | m³/h        | l/s |               |          |          |         |      |
| REC 280 AC   | 280         | 78  | 230           | 236      | 1        | 26      | 27,5 |
| REC 320 EC  | 320         | 89  | 230           | 100      | 0,90     | 26      | 28   |

\* Lp(A) at 3 m in open field at the maximum aerualic efficiency point (min. speed AC version and speed setting 60% EC version)

# DIMENSIONS (mm)

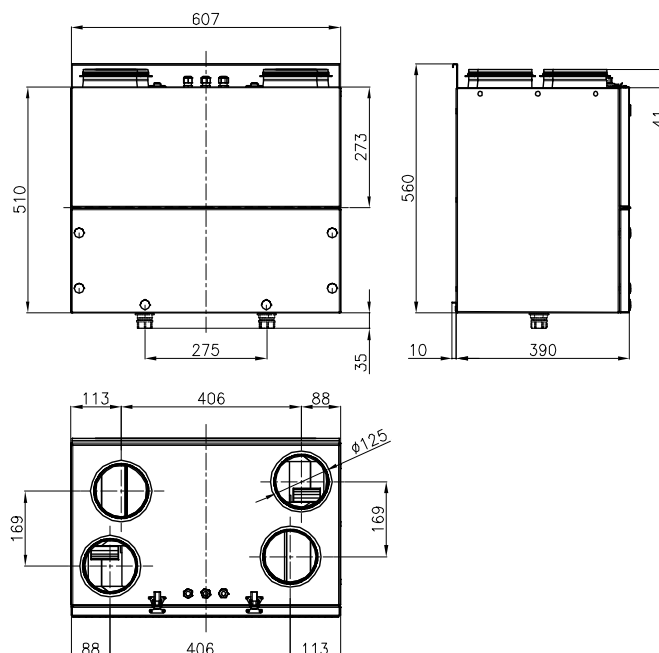

# EFFICIENCY GRAPH

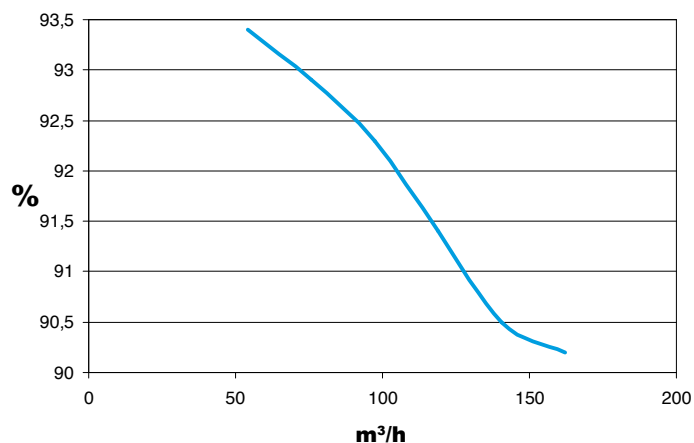

# CURVES

