

### DESCRIPTION

- High performance and high efficiency centrifugal fans for roof installation
- Easy and cost-effective solution for a centralized ventilation requirement
- Complete range: 7 models available in sizes  $\varnothing$  100 to 315 mm
- Compact sizes
- Available with square roof curb

### FEATURES

- Made in aluminium and steel sheet with epoxy finish highly resistant to atmospheric agents.
- Suitable for clean air at max temperature of +60°C
- Ball bearing EC motor and backward curved blades
- Impeller in technopolymer. Statically and dynamically balanced according to ISO 1940
- Suitable for continuous running
- Speed controllable
- Comply with CEI EN 60335-2-80, EMC 2014/30/UE, LVD 2014/35/UE



**Comply with ErP Directive 2009/125/CE and UE Regulation 1253/2014.**

Non Residential Ventilation Unit.

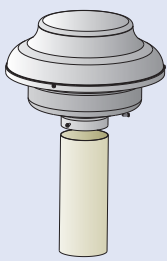

**MRF**

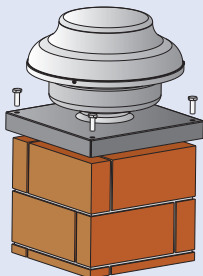

**MRF/BA**

#### MODELS

- MRF
- MRF with square roof curb

### INSTALLATION

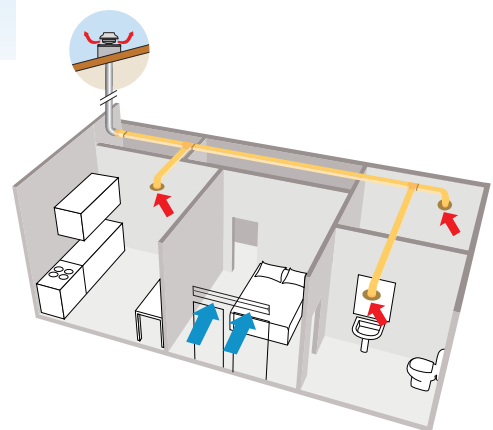
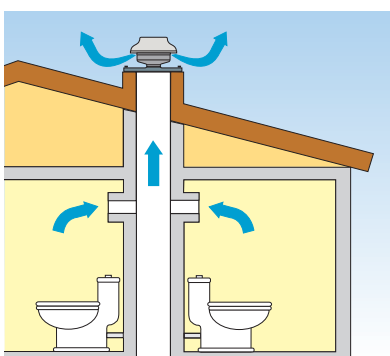
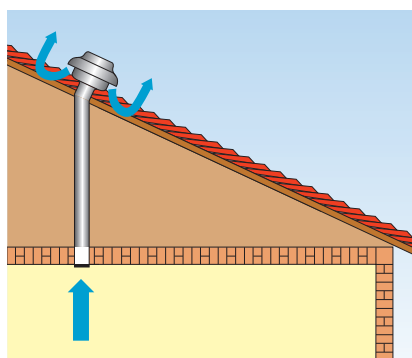
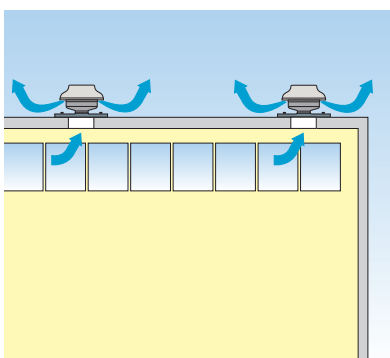

## PERFORMANCE

Model	m <sup>3</sup> /h	l/s	Pa	W	A	LwA dB(A)*	LpA
MRF 100 EC	395	110	765	78	0,70	77	56
MRF 125 EC	431	120	720	75	0,70	77	56
MRF 150 EC	608	169	518	78	0,70	73	53
MRF 160 EC	682	189	524	85	0,77	72	52
MRF 200 EC	745	207	538	85	0,77	68	48
MRF 250 EC	725	201	495	85	0,77	70	49
MRF 315 EC	1184	329	607	175	1,50	74	53

\*LWA: sound power according to ISO 3746

\*LPA: sound pressure at 3 m in open field (inlet side)

## DIMENSIONS (mm)

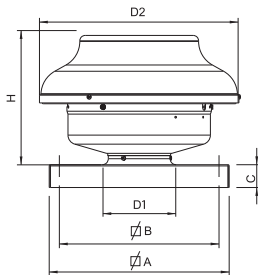

MODELS	D1	D2	H	∅ A	∅ B	C	Kg	Kg*
MRF 100 EC	98	333	225	300	265	36	3,1	4,6
MRF 125 EC	122	333	225	300	265	36	3,1	4,6
MRF 150 EC	147	405	266	400	360	36	4,2	6,2
MRF 160 EC	157	405	266	400	360	36	5	6,2
MRF 200 EC	198	405	266	400	360	36	5,5	6,8
MRF 250 EC	248	405	266	400	360	36	6	7,3
MRF 315 EC	314	484	322	400	360	36	7	10

\* Models with square roof curb

## CURVE

