



# BUILT-IN

Built-in wall axial fans  
Wall installation



Comply with ErP Directive 2009/125/CE  
and EU Regulation 327/2011

Classification: FAN

- Extract/Intake models available in 2 sizes: 9" and 12" (with same wall hole sizes)
- Built-in 9 available in Low capacity version
- Stylish profile and unobtrusive installation
- High efficiency (up to 1630 m<sup>3</sup>/h)
- Silent shutter operation via thermal actuator
- Made in shockproof high quality technopolymer
- Sleeve bearing motor



## PERFORMANCE

MODELS	m <sup>3</sup> /h	l/s	Pa	W	dB (A)**	Kg
<b>BUILT-IN 9</b>	* 740 / 480	205 / 133	46 / 35	46	48	11,5
<b>BUILT-IN 12</b>	* 1630 / 850	453 / 236	75 / 48	106	58	12,5
<b>BUILT-IN 9 LC</b>	* 600 / 374	167 / 104	42 / 35	29	48	11,5

\* Extract / Intake

\*\* Lp(A) measured at 3m in open field 230V-50Hz.

## DIMENSIONS (mm)

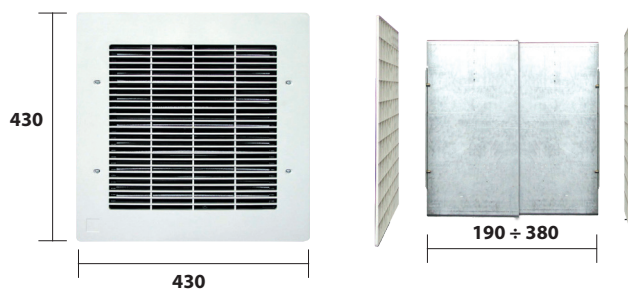

## INSTALLATION

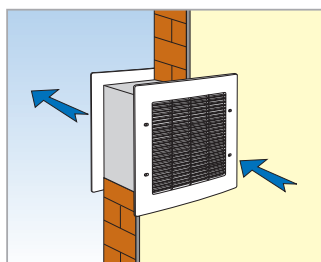

Hole dimensions  
(same hole size for 9" and 12")

